

# Vog|Variety



# The Art of *Perfect Shape!*

**Vog|Variety** standard product range

## Meeting high standards Top class moulded components

Products of the VoglVariety line are fibre-reinforced gypsum elements (G.R.G.).

The combination of special material composition and applied laminating technology opens up almost unlimited design possibilities. Any conceivable geometric shape, three-dimensional construction or exceptional design can be implemented.



### Advantages for you:

- Individual design
- Complex two- and three-dimensional shapes can be produced
- High surface hardness and rigidity
- Low own weight
- Time-saving installation
- Efficient logistics and practical handling on the job site
- Material class A1 (non-combustible)



## Ceiling elements

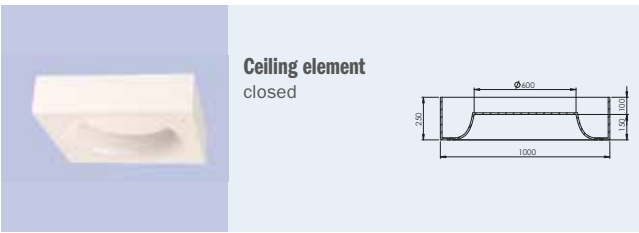

**Ceiling element**  
closed

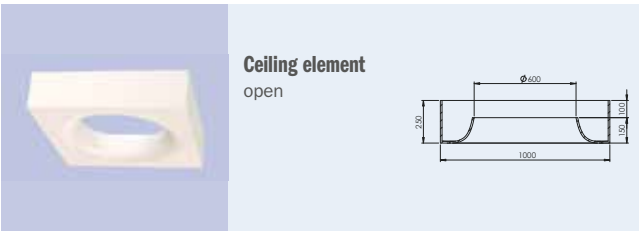

**Ceiling element**  
open

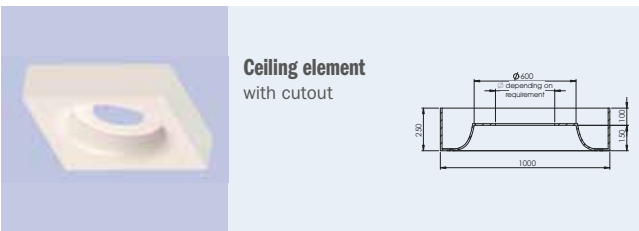

**Ceiling element**  
with cutout

## Light channel profiles

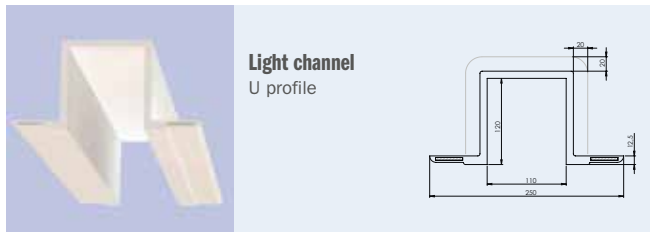

**Light channel**  
U profile

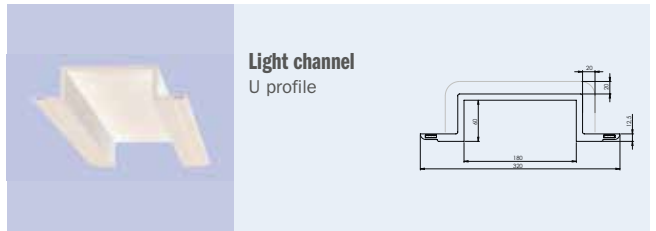

**Light channel**  
U profile

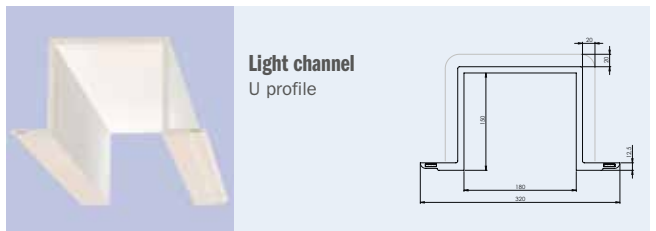

**Light channel**  
U profile

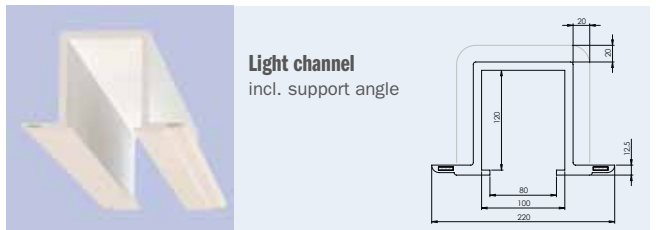

**Light channel**  
incl. support angle

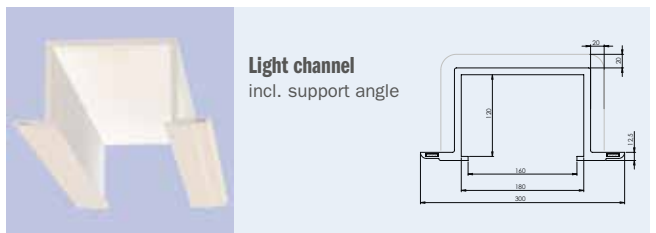

**Light channel**  
incl. support angle

## Coved lighting

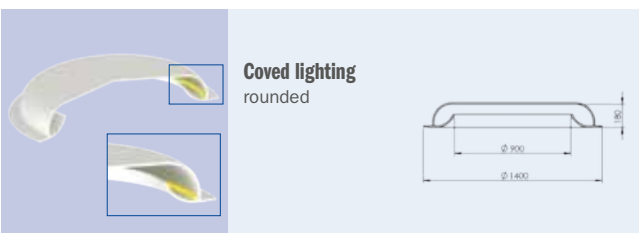

**Coved lighting**  
rounded

## Suspended luminaire

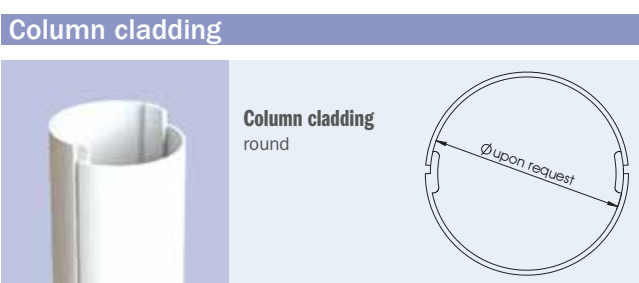

**Column cladding**  
round

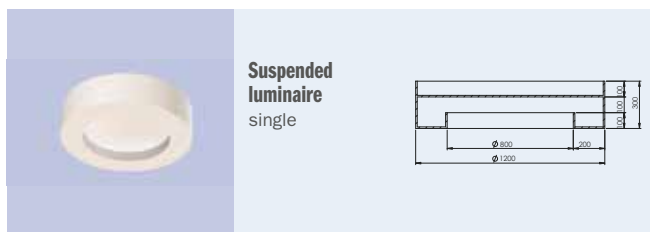

**Suspended luminaire**  
single

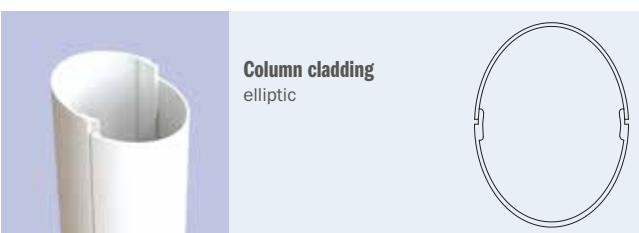

**Column cladding**  
elliptic

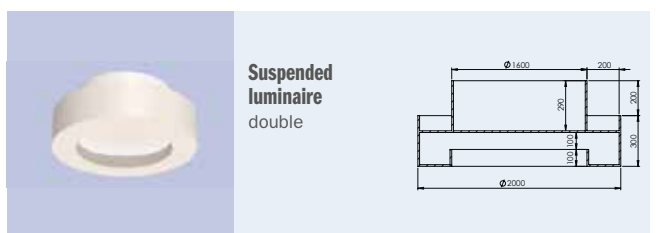

**Suspended luminaire**  
double

## Funnels



**Funnel**  
concave

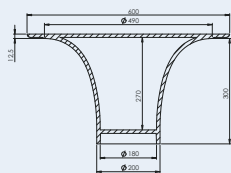

**Funnel**  
closed, convex

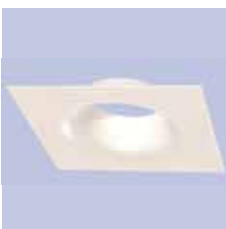
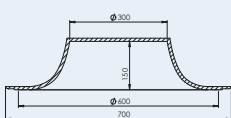

**Funnel**  
open, convex

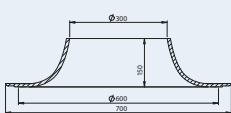

**Funnel**  
with cutout,  
convex

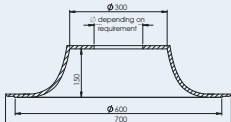

**Funnel**  
closed, convex

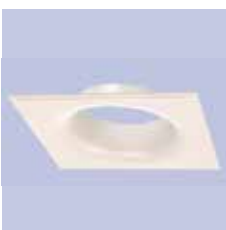
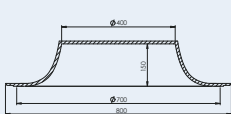

**Funnel**  
open, convex

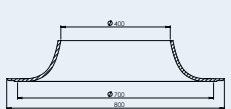

**Funnel**  
with cutout,  
convex

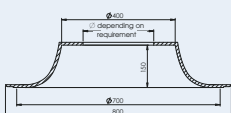

## Funnels



**Funnel**  
closed, convex

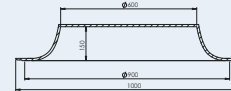

**Funnel**  
open, convex



**Funnel**  
with cutout,  
convex

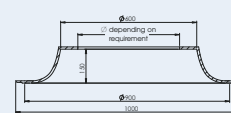

**Funnel**  
closed, convex

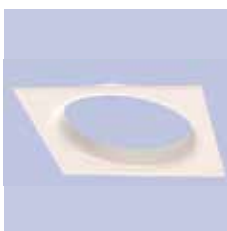
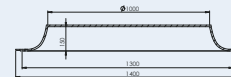

**Funnel**  
open, convex



**Funnel**  
with cutout,  
convex

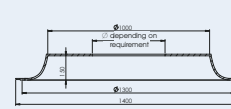

## Projection sections

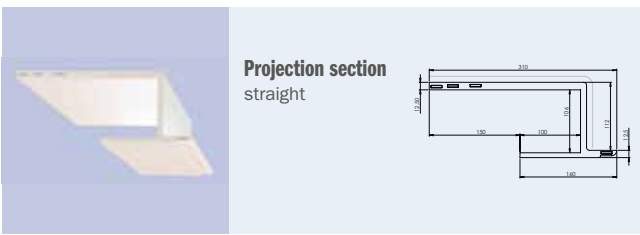

**Projection section**  
straight

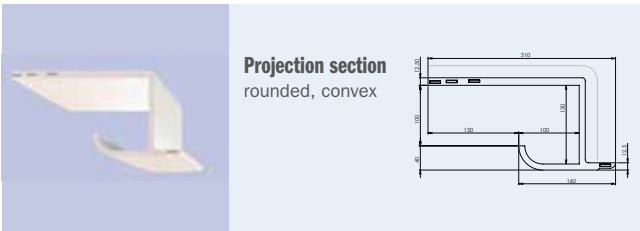

**Projection section**  
rounded, convex

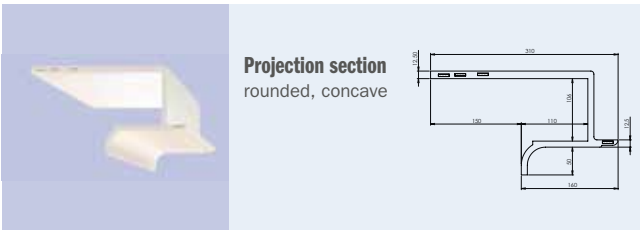

**Projection section**  
rounded, concave

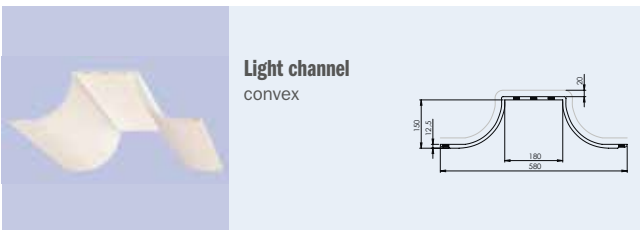

**Light channel**  
convex

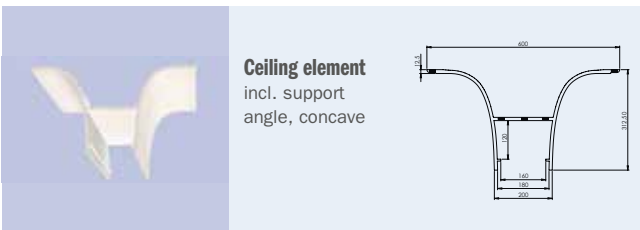

**Ceiling element**  
incl. support  
angle, concave

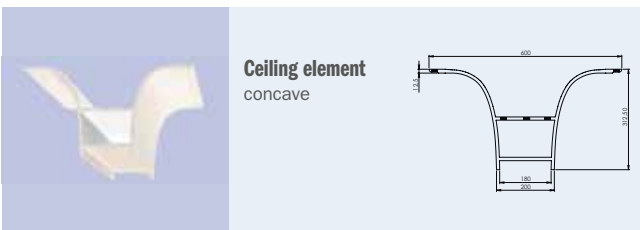

**Ceiling element**  
concave

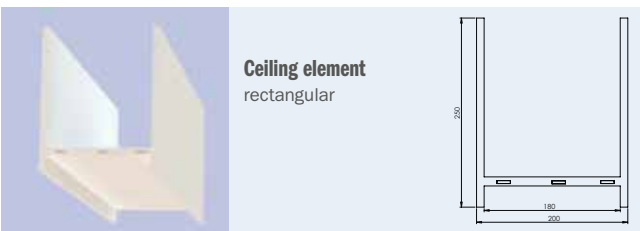

**Ceiling element**  
rectangular

## Corners

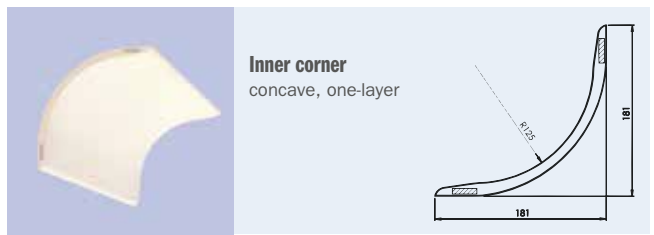

**Inner corner**  
concave, one-layer

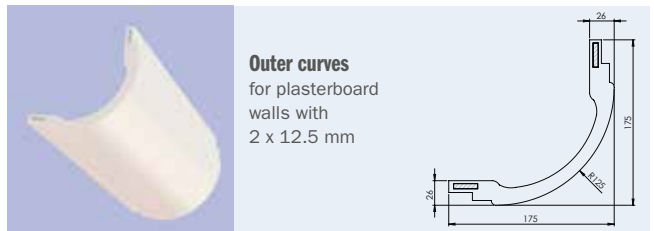

**Outer curves**  
for plasterboard  
walls with  
2 x 12.5 mm

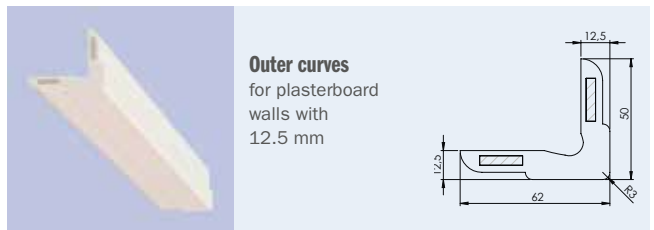

**Outer curves**  
for plasterboard  
walls with  
12.5 mm

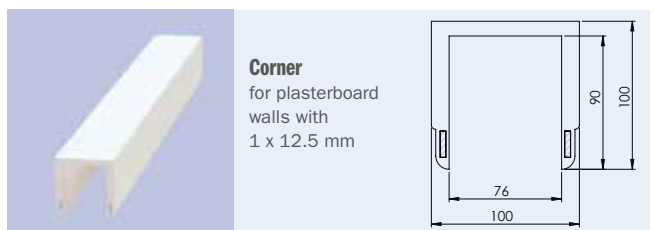

**Corner**  
for plasterboard  
walls with  
1 x 12.5 mm

## Built-in elements

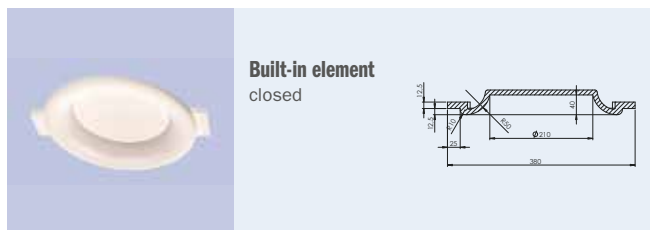

**Built-in element**  
closed

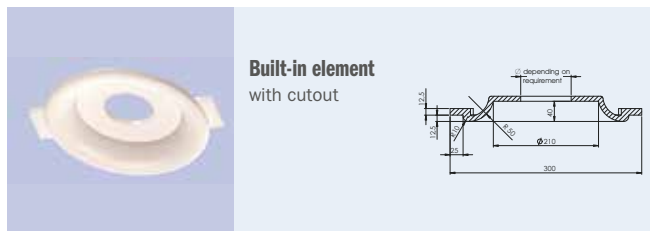

**Built-in element**  
with cutout



**Vogl Deckensysteme GmbH**

Industriestrasse 10  
DE-91448 Emskirchen

Phone +49 9104 825-0  
Fax +49 9104 825-250

info@vogl-ceilingssystems.com  
www.vogl-ceilingssystems.com



Errors, printing faults and technical changes reserved. Consumption, quantity and design details are based on empirical values. The details contained in this text correspond to the current state of technology. Any relevant valid building technology regulations, standards and guidelines must be observed in addition to our processing instructions. All rights reserved. Reprints as well as electronic reproduction, even extracts, require the express approval of Vogl Deckensysteme GmbH, Industriestrasse 10, 91448 Emskirchen, Germany.

PICTURE CREDITS

Page 1: mecano architecten - Page 5 top left: Zooney Braun - Page 5 centre left: Zooney Braun - Page 5 top right: mecano architecten - Page 5 bottom: Franz Brück - Page 6: mecano architecten

Status 05/2018