

Voglfalt-Fix®

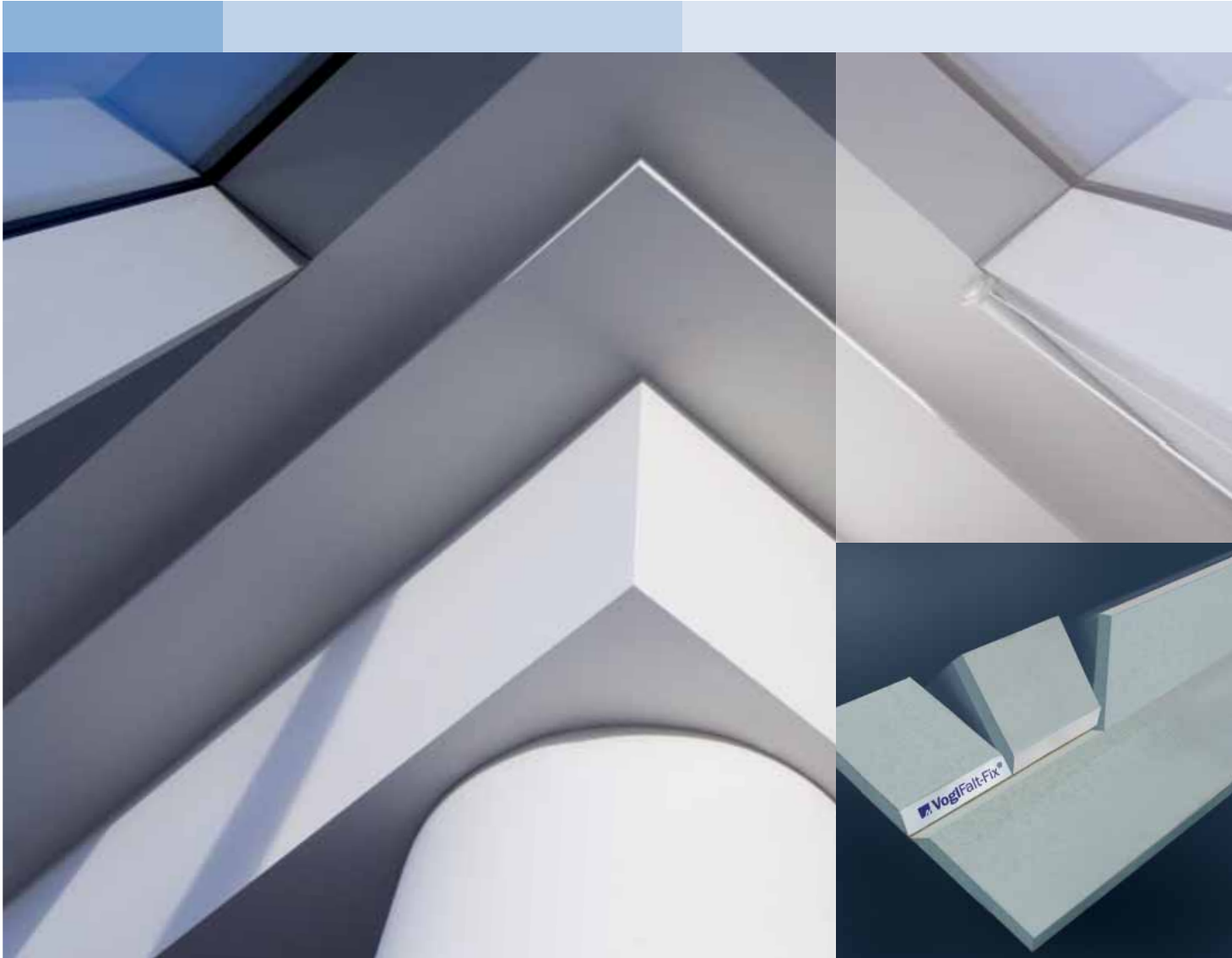

Precise edges
almost automatically

Position moldings easy, quick
and exact

Record results without effort on all corners and edges

Clean, exact and equal corner connection of the panel edges in covers and form components of plasterboard are a special challenge for the installation. Under common site conditions, this work step is almost like a piece of art.

The effort that needs to be taken for perfect results is either very large – or very small with VoglFalt-Fix®. Form components with VoglFalt-Fix® are milled so clever that the stable paper cover of the plasterboard remains undamaged. The lastingly stable connection is

performed with a pre-integrated double sided adhesive VoglFalt-Fix® strip. The installation at the construction site is then no longer challenging but rather very simple and applicable with a few steps.

Systematic Security:
The Vogl Suspension System assures
absolute plain installation

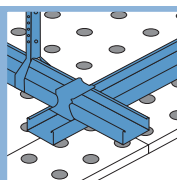

Ne plus ultra for simple installation

The modern method to apply moldings:

- Space saving, economical transport due to flat delivery for economic construction site handling
- Significantly reduces time consumption and costs for stepped form components and coverings
- The VogIFalt-Fix® strip immediately provides strongest and lasting adhesive strength
- Used as a corner angle even after bonding bonding the flexible fold can be adjusted by +/- 1°
- Precise pre-fabrication and simple installation without time consuming finishing work provide maximum application and result reliability
- Rational processing on perforated ceiling panels easily realized

VogIFalt-Fix®

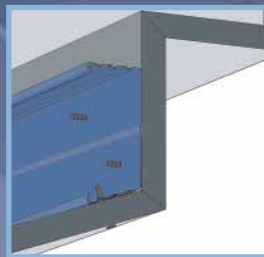

- ⊕ The corner connections are quickly realized – including clean edges
- ⊕ No need for a complicated substructure behind the edge
- ⊕ Enormous time saving and absolutely clean working at the construction site

Conventional corner formation

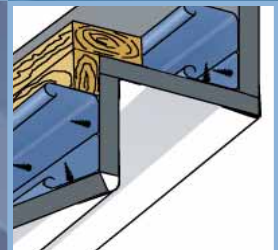

- ⊖ Single components require elaborate substructures for forming
- ⊖ Time consuming screwing for acquiring the corner and edge formation
- ⊖ Edge formations must be finished and sanded several times

VogIFalt-Fix® – an inseparable connection – can't be done easier or quicker



Remove covering from VogIFalt-Fix® strip



Fold the sides of the component in the final position

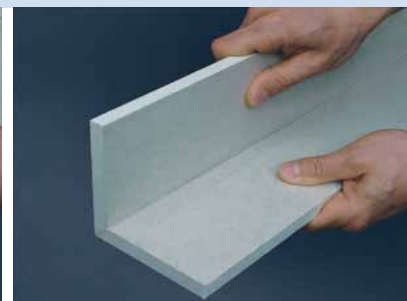

Lightly press the component edges after reaching the final position



System demonstration: Perfect edge formation with minimal effort



Please see our multi-function online support for brochures, newsletters, design details, specifications and installation manuals, all available as animated PDF documents.

More at:
www.vogl-deckensysteme.com

www.vogl-formitekt.de
www.vogl-deckensysteme.de

Fax response + 49 (0) 9104 - 825 - 250

- | | | | |
|---|-----------------------|---|--------------------------|
| <input type="checkbox"/> I would like to know more and am requesting information concerning: | VogJoint | <input type="checkbox"/> VoglToptec®Ultracoustic | <input type="checkbox"/> |
| | Vog Frieze Tape Set | <input type="checkbox"/> Vogl Double Layer Fleece | <input type="checkbox"/> |
| | VogFalt-Fix® | <input type="checkbox"/> Vogl Stretch Ceilings | <input type="checkbox"/> |
| <input type="checkbox"/> I have a specific project. A Vogl ceiling specialist should contact me to schedule an appointment. | Vog Floating Ceilings | <input type="checkbox"/> Vogl Suspension Systems | <input type="checkbox"/> |
| | Vog Color Panel | <input type="checkbox"/> Vogl Joint Compound | <input type="checkbox"/> |
| | Vog Adsorber Panel | <input type="checkbox"/> Vogl Ceiling Tiles | <input type="checkbox"/> |
| | Vog3D-Design | <input type="checkbox"/> Vogl Access Panels | <input type="checkbox"/> |
| | VogToptec®Color | <input type="checkbox"/> VoglThermotop®Climate Ceilings | <input type="checkbox"/> |
| | VogToptec®Acoustic | <input type="checkbox"/> VoglModu®QuadRound | <input type="checkbox"/> |

Name ⌈ ⌋

Company ⌈ ⌋

Street ⌈ ⌋

City, zip code ⌈ ⌋

Telephone ⌈ ⌋

Telefax ⌈ ⌋

E-Mail ⌈ ⌋

Vogl Deckensysteme GmbH

Industriestrasse 10 • 91448 Emskirchen
 Telephone +49 (0) 9104-825-0 • Telefax +49 (0) 9104-825-250
info@vogl-deckensysteme.de • www.vogl-deckensysteme.de

